

O'Connor Park Playground Replacement Public Engagement Summary

On September 13, 2021, a virtual public information session was held via Zoom for the playground at O'Connor Park, LaSalle Park, and Lake Ontario Park (north). Fifteen (15) residents attended the online session. The concepts proposed and the site constraints were explained during the information session, which can be viewed on [YouTube](#).

Feedback was received through email and an online survey through Get Involved Kingston from September 13 to October 5, 2021. Public feedback was collected from 95 respondents.

Summary of feedback on proposed playground

- 65% of respondents preferred Option 2

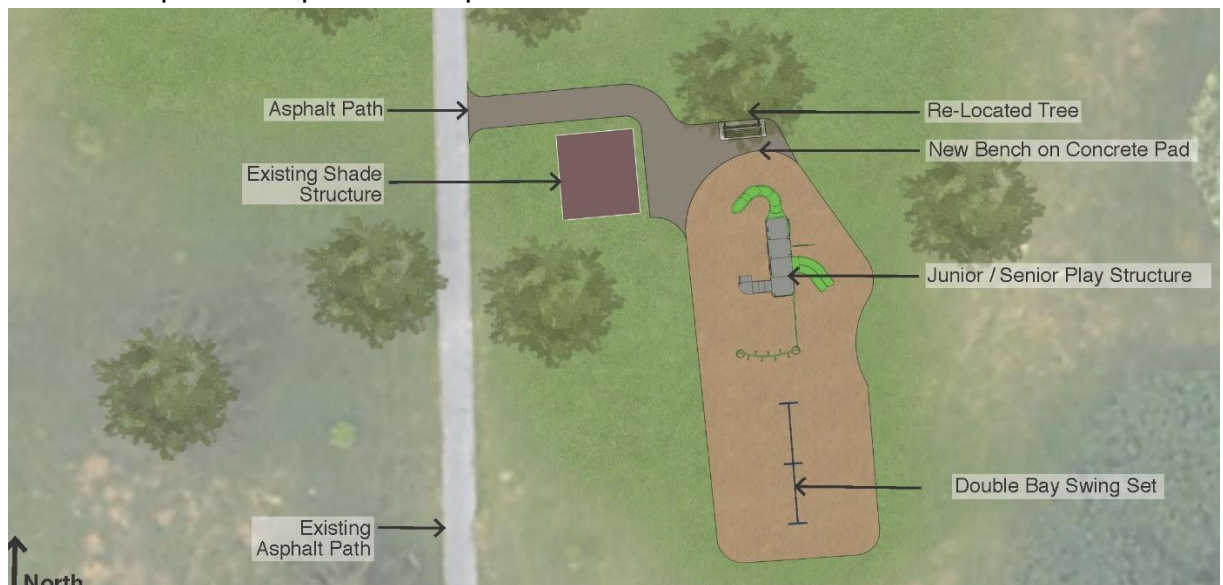

- It was indicated that the fireman pole was a favourite element on the old play structure, and that many are interested in a teeter totter
- Some respondents wanted more swings and had indicated that baby swings are important to young families
- A few respondents wanted a climbing cage or a net climber
- A few respondents wanted natural play equipment like stepping rock paths, logs, and natural climbers
- A respondent questioned if there is even enough use to justify a new playground, while another respondent was glad to see improvements finally taking place in the park

- Some feel that having separate playground areas is better for separating the age groups, providing more space on busy summer weekends, or for COVID related concerns, while on the other hand, it is harder to supervise
- There were varying opinions on the existing condition and salvation of the old senior structure, junior structure, and baby swings
- One respondent suggested keeping the sand safety surface as kids like to play in it

Summary of other park comments

- Some respondents wanted more seating near the playground. Both formal and informal.
- Some respondents suggest a picnic table in the shade shelter near the playground
- There were concerns the main pathway has trip hazards and can be icy in the winter
- Some suggested providing more garbage cans and placing them closer to the center of the park
- Some respondents wanted more trees for shade or windbreak and had indicated the trees at the top of the hill near Glenaire Mews entrance are important for summer picnics
- A few respondents wanted improvements to the west hill and surrounding area to improve the safety of tobogganing in the winter
- One respondent suggested paving the existing outdoor rink area so it can be used to play games in the summer
- There were requests for other amenities in the park such as outdoor fitness equipment, dog park, basketball, splash pad, pool, wading pool, drinking fountain, garden, bike racks, BBQ, a needle bin, tennis, and pickleball courts

Response to feedback

- **There is a lot of room in the park, why not keep the existing structures and add more structures?**

Many of the existing structures are past their life cycle and were brought forward as a priority due to the existing condition and risk. The proposed playground replacement is the most we can provide within the available budget. Park slopes and underground infrastructure limit where the playground can be located.

- **Why not keep the existing junior and add a junior / senior structure instead of just a new senior structure?**

A junior / senior structure is more expensive and takes up more space than just a senior structure on its own.

- **Why are there fewer swings proposed than existing?**

The double bay swing set is the most we can provide with the available budget. To increase the amount of swings, a smaller play structure would need to be considered.

- **Can we have natural play equipment here?**

Natural styled play equipment is more expensive and would result in a smaller playground for the available budget. In addition, due to their shorter lifespan and higher maintenance costs, the City is selectively considering the use of natural styled equipment. Usually, parks with existing natural features such as woodlots may be considered.

- **What material is the safety surface?**

The proposed playground safety surface is engineered wood fiber.

- **Can we locate the playground closer to the mature trees to provide more shade?**

Unfortunately, placing the playground any closer to the pathway where the existing shade trees exist isn't possible due to underground infrastructure.

- **Will any new pathways be proposed in the park to connect to the existing path such as from Glenaire Mews?**

It is not in the current budget to connect the pathway, but the playgrounds have been designed to allow for a future connection.

- **Will the main pathway be fixed in the park?**

No, the scope of the improvement does not include updating the pathway due to available budget. We will continue to monitor the pathway condition for future improvements.

- **Are other amenities like outdoor fitness equipment, splash pad, courts, etc proposed as part of the improvement?**

No, the scope of the improvement is to replace the old playground equipment to meet current standards. The [City's Park and Recreation Master Plan](#) outlines future park amenities in the City.

Next Steps

- Option 2 will be implemented and a fireman's pole and teeter totter will be added in response to feedback.



- Construction is planned for 2022
- Relevant City departments have been made aware of the other park operational concerns that were raised through the consultation